

FORT CAMPBELL
FORT CAMPBELL, KENTUCKY

BASIC INFORMATION MAPS

**GENERAL
STORM SEWER SYSTEM
MAPS**



ENGINEERING, SCIENCE,
AND TECHNOLOGY, INC.

NOVEMBER, 2003

CREWING NAME C:\Users\A\My Documents\EA\1372204.dwg 11/13/2004 11:25:24 AM

SHEET NUMBER	COVER	STATUS
1	COVER	
2	INDEX	
3	CREATED - Nov 2003	
4	CREATED - Nov 2003	
5	CREATED - Nov 2003	
6	CREATED - Nov 2003	
7	CREATED - Nov 2003	
8	CREATED - Nov 2003	
9	CREATED - Nov 2003	
10	CREATED - Nov 2003	
11	CREATED - Nov 2003	
12	CREATED - Nov 2003	
13	CREATED - Nov 2003	
14	CREATED - Nov 2003	
15	CREATED - Nov 2003	
16	CREATED - Nov 2003	
17	CREATED - Nov 2003	
18	CREATED - Nov 2003	
19	CREATED - Nov 2003	
20	CREATED - Nov 2003	
21	CREATED - Nov 2003	
22	CREATED - Nov 2003	
23	CREATED - Nov 2003	
24	CREATED - Nov 2003	
25	CREATED - Nov 2003	
26	CREATED - Nov 2003	
27	CREATED - Nov 2003	
28	CREATED - Nov 2003	
29	CREATED - Nov 2003	
30	CREATED - Nov 2003	
31	CREATED - Nov 2003	
32	CREATED - Nov 2003	
33	CREATED - Nov 2003	
34	CREATED - Nov 2003	
35	CREATED - Nov 2003	
36	CREATED - Nov 2003	
37	CREATED - Nov 2003	
38	CREATED - Nov 2003	
39	CREATED - Nov 2003	
40	CREATED - Nov 2003	
41	CREATED - Nov 2003	
42	CREATED - Nov 2003	
43	CREATED - Nov 2003	
44	CREATED - Nov 2003	
45	CREATED - Nov 2003	
46	CREATED - Nov 2003	
47	CREATED - Nov 2003	
48	CREATED - Nov 2003	
49	CREATED - Nov 2003	
50	CREATED - Nov 2003	
51	CREATED - Nov 2003	
52	CREATED - Nov 2003	
53	CREATED - Nov 2003	
54	CREATED - Nov 2003	
55	CREATED - Nov 2003	
56	CREATED - Nov 2003	
57	CREATED - Nov 2003	
58	CREATED - Nov 2003	
59	CREATED - Nov 2003	
60	CREATED - Nov 2003	
61	CREATED - Nov 2003	
62	CREATED - Nov 2003	
63	CREATED - Nov 2003	
64	CREATED - Nov 2003	
65	CREATED - Nov 2003	
66	CREATED - Nov 2003	
67	CREATED - Nov 2003	
68	CREATED - Nov 2003	
69	CREATED - Nov 2003	
70	CREATED - Nov 2003	
71	CREATED - Nov 2003	
72	CREATED - Nov 2003	
73	CREATED - Nov 2003	
74	CREATED - Nov 2003	
75	CREATED - Nov 2003	
76	CREATED - Nov 2003	
77	CREATED - Nov 2003	
78	CREATED - Nov 2003	
79	CREATED - Nov 2003	
80	CREATED - Nov 2003	
81	CREATED - Nov 2003	
82	CREATED - Nov 2003	
83	CREATED - Nov 2003	
84	CREATED - Nov 2003	
85	CREATED - Nov 2003	
86	CREATED - Nov 2003	
87	CREATED - Nov 2003	

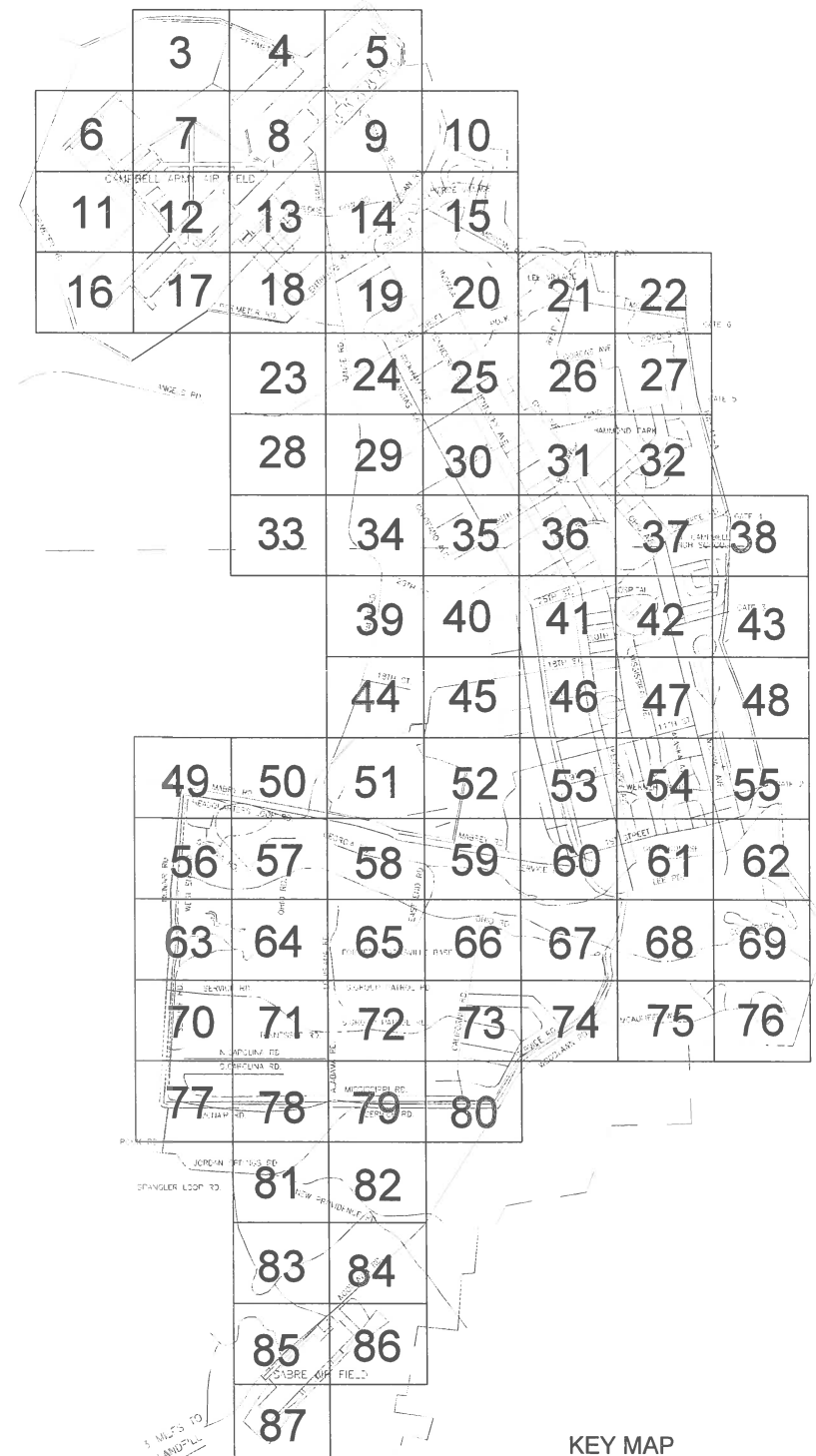

KEY MAP

DATE: 11/13/2003
 TIME: 10:52 AM
 DRAWN BY: E.C.

PROJECT NUMBER			
REVIEWED APPROVED			
THE SIGNATURES APPEARING IN THIS BLOCK CONSTITUTE APPROVAL OF ALL DRAWINGS IN THIS PROJECT. ORIGINAL SIGNED AND ON FILE.			
TITLE	SIGNATURE	DATE	
CH. PUBLIC SWEET			
CH. FIRE DEPT.			
CH. MASTER PLANS			
CH. ENGINEERING DW.			
CH. ENVIRONMENTAL DW.			
CH. MAINTENANCE DW.			
CH. BUSINESS MGMT DW.			
CH. HOUSING DW.			
CH. PREVENTIVE MEDICINE			
USING AGENCY			
REVISION	DATE	DESCRIPTION	BY
PUBLIC WORKS BUSINESS CENTER FORT CAMPBELL, KENTUCKY			
PROJECT REVIEWED AND WILL NOT RESULT IN ADVERSE ENVIRONMENTAL IMPACT CODE			
SCALE		AS SHOWN	
DRAWN BY		EG	
DESIGNED BY		LMS	
CHECKED BY		HEB	
APPROVED			
SR. ENGR. DIRECTOR, PUBLIC WORKS BUSINESS CENTER			DATE: Nov 2003
			DRAWING NUMBER
			SHT. 2 OF 87 SHT.

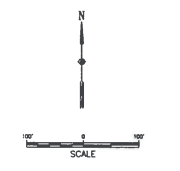
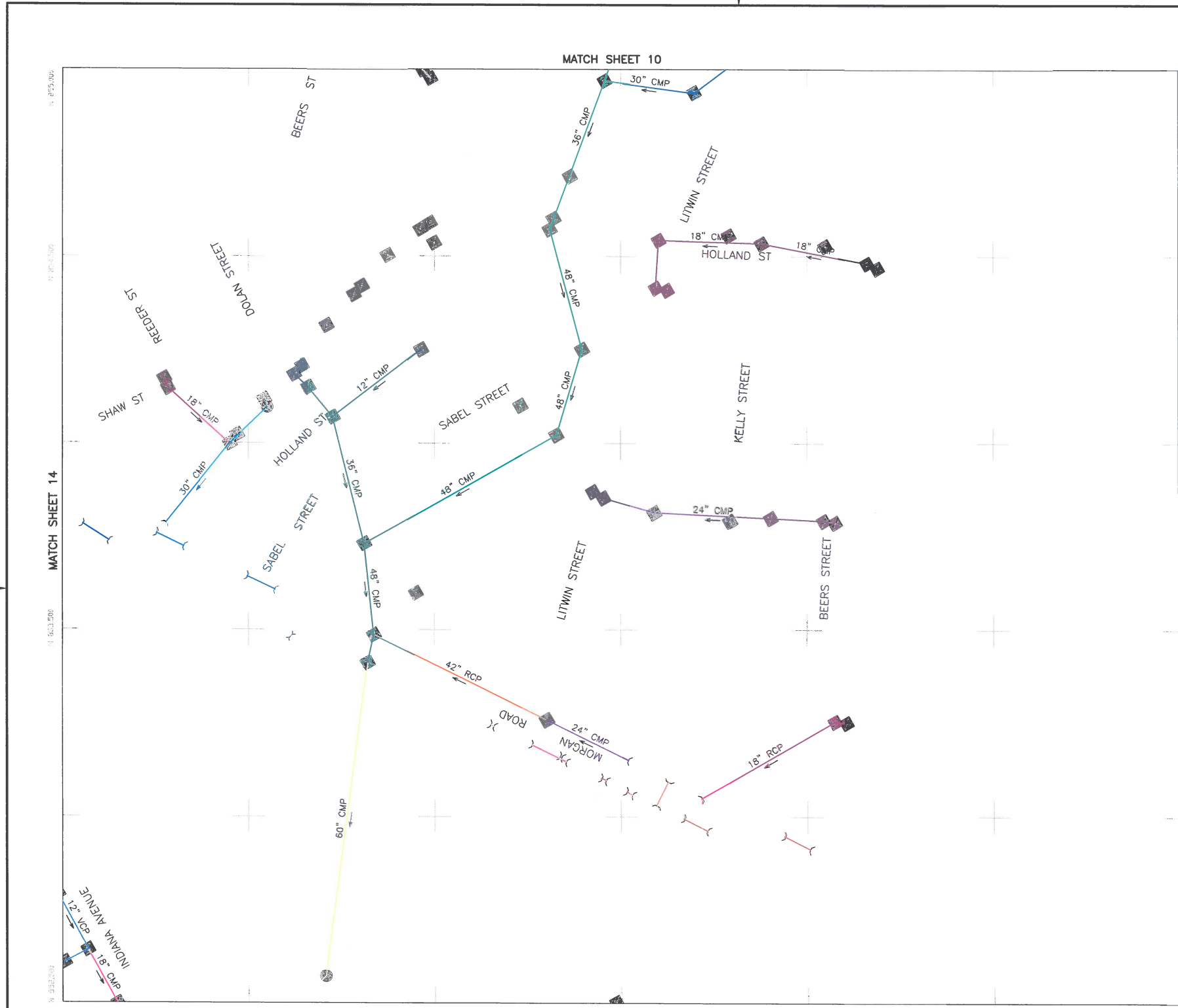

THIS DRAWING HAS BEEN REDUCED TO ONE HALF THE ORIGINAL SCALE

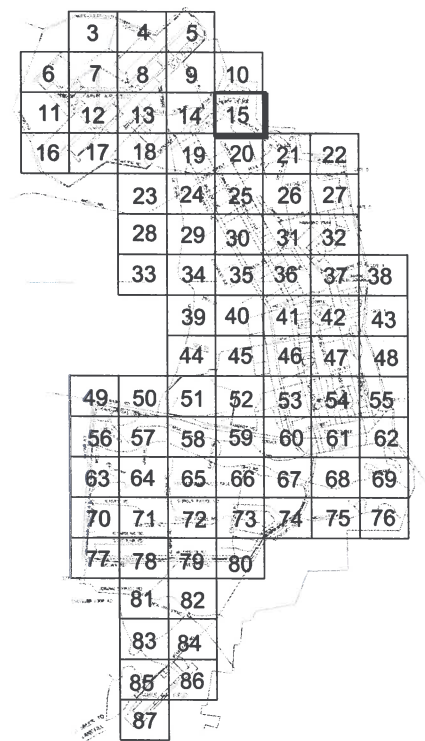

KEY MAP

- NOTES:**
1. AERIAL PHOTOGRAPH DATE - 2001
 2. SURVEY COMPLETION DATE - NOT APPLICABLE
 3. 500' GRID BASED ON TENNESSEE STATE PLANE COORDINATE SYSTEM
 - HORIZONTAL DATUM NAD83
 - VERTICAL DATUM NAVD83
 4. NFV - NOT FIELD VERIFIED
 STRUCTURE WAS SHOWN ON PREVIOUS DOCUMENTS BUT WAS NOT FOUND DURING FIELD INVESTIGATIONS.
 STRUCTURE HIGHLY LIKELY TO EXIST DENOTED BY ● AND ■
 STRUCTURE OF QUESTIONABLE EXISTENCE DENOTED BY ○ AND □
 5. ASL - ASSUMED LOCATION
 STRUCTURE WAS NOT SHOWN ON PREVIOUS DOCUMENTS OR FOUND DURING FIELD INVESTIGATIONS BUT EXISTENCE IS HIGHLY LIKELY.

- UTILITY LEGEND**
- 48" RCP - STORM SEWER LINE (SEE SUPPLEMENT ENTITLED "STRUCTURE AND PIPE ELEVATIONS, SIZES, AND MATERIALS" FOR ADDITIONAL INFORMATION)
 - UNKNOWN ORIGIN OR ENDPOINT OF STORM SEWER LINE
 - MANHOLE AND MANHOLE NUMBER
 - MANHOLE OF QUESTIONABLE EXISTENCE (SEE NOTE 4)
 - INLET AND INLET NUMBER
 - INLET OF QUESTIONABLE EXISTENCE (SEE NOTE 4)
 - ⌒ ROOF DRAIN OR OTHER SMALL DIAMETER SUBSURFACE DRAINAGE PIPE
 - ⌒ PIPE OR CULVERT END OR ENDWALL
 - FLOW DIRECTION ARROWS
 - NFV NOT FIELD VERIFIED (SEE NOTE 4)
 - ASL ASSUMED LOCATION (SEE NOTE 5)
 - ⊕ CLASS V SINKHOLE
 - NON-CLASS V SINKHOLE

- MATERIALS OF CONSTRUCTION**
- C - CONCRETE
 - CI - CAST IRON
 - CMP - CORRUGATED METAL PIPE
 - PVC - POLYVINYL CHLORIDE
 - RCP - REINFORCED CONCRETE PIPE
 - VCP - VITRIFIED CLAY PIPE
 - PLASTIC
 - STEEL

PROJECT NUMBER			
REVIEWED APPROVED			
THE SIGNATURES APPEARING IN THIS BLOCK CONSTITUTE APPROVAL OF ALL DRAWINGS IN THIS PROJECT. ORIGINAL SIGNED AND ON FILE.			
REVISION	DATE	DESCRIPTION	BY
TITLE		SIGNATURE	DATE
CH. PUBLIC WORKS			
CH. TRAFFIC			
CH. MASTER PLANS			
CH. ENGINEERING DIV.			
CH. ENVIRONMENTAL DIV.			
CH. MAINTENANCE DIV.			
CH. BUSINESS MGMT. DIV.			
CH. HOUSING DIV.			
CH. PREVENTIVE MEDICINE			
USING AGENCY			
SCALE		AS SHOWN	
DRAWN BY		ES	
DESIGNED BY		LMS	
CHECKED BY		HEB	
APPROVED		DATE: Sep 2005	
SR. ENGR.		DRAWING NUMBER: SH15 OF 87 SH11	
PUBLIC WORKS BUSINESS CENTER FORT CAMPBELL, KENTUCKY			
PROJECT REVIEWED AND WILL NOT RESULT IN ADVERSE ENVIRONMENTAL IMPACT CODE			
STORM SEWER SYSTEM			

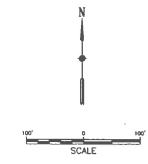

THIS DRAWING HAS BEEN
REDUCED TO ONE HALF
THE ORIGINAL SCALE

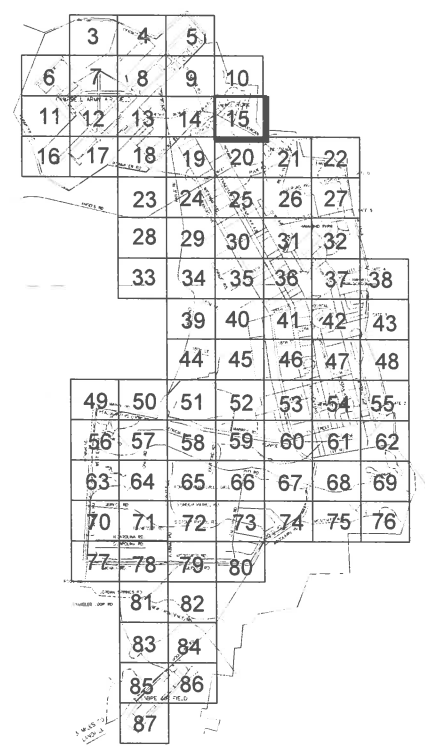

KEY MAP

E 1:537,000

E 1:533,000

MATCH SHEET 20

E 1:539,000

E 1:540,000

NOTES:

1. AERIAL PHOTOGRAPH DATE - 2001
2. SURVEY COMPLETION DATE - NOT APPLICABLE
3. 500' GRID BASED ON TENNESSEE STATE PLANE COORDINATE SYSTEM
 - HORIZONTAL DATUM NAD83
 - VERTICAL DATUM NAVD88
4. NFV - NOT FIELD VERIFIED
STRUCTURE WAS SHOWN ON PREVIOUS DOCUMENTS BUT WAS NOT FOUND DURING FIELD INVESTIGATIONS.
STRUCTURE HIGHLY LIKELY TO EXIST DENOTED BY ⊗ AND ⊠
STRUCTURE OF QUESTIONABLE EXISTENCE DENOTED BY ○ AND □
5. ASL - ASSUMED LOCATION
STRUCTURE WAS NOT SHOWN ON PREVIOUS DOCUMENTS OR FOUND DURING FIELD INVESTIGATIONS BUT EXISTENCE IS HIGHLY LIKELY.

UTILITY LEGEND

- 48" RCP - STORM SEWER LINE (SEE SUPPLEMENT ENTITLED "STRUCTURE AND PIPE ELEVATIONS, SIZES, AND MATERIALS" FOR ADDITIONAL INFORMATION)
- UNKNOWN ORIGIN OR ENDPOINT OF STORM SEWER LINE
- ⊗ MANHOLE AND MANHOLE NUMBER
- ⊠ MANHOLE OF QUESTIONABLE EXISTENCE (SEE NOTE 4)
- INLET AND INLET NUMBER
- INLET OF QUESTIONABLE EXISTENCE (SEE NOTE 4)
- ⊕ ROOF DRAIN OR OTHER SMALL DIAMETER SUBSURFACE DRAINAGE PIPE
-) PIPE OR CULVERT END OR ENDWALL
- FLOW DIRECTION ARROWS
- NFV NOT FIELD VERIFIED (SEE NOTE 4)
- ASL ASSUMED LOCATION (SEE NOTE 5)
- ⊕ CLASS V SINKHOLE
- ⊙ NON-CLASS V SINKHOLE

MATERIALS OF CONSTRUCTION

- C - CONCRETE
- CI - CAST IRON
- CMP - CORRUGATED METAL PIPE
- PVC - POLYVINYL CHLORIDE
- RCP - REINFORCED CONCRETE PIPE
- VCP - VITRIFIED CLAY PIPE
- PLASTIC
- STEEL

PROJECT NUMBER			
REVIEWED APPROVED			
THE SIGNATURES APPEARING IN THIS BLOCK CONSTITUTE APPROVAL OF ALL DRAWINGS IN THIS PROJECT. ORIGINAL SIGNED AND ON FILE.			
TITLE	SIGNATURE	DATE	
CH. PUBLIC SWEET			
CH. FIRE DEPT.			
CH. MASTER PLANS			
CH. ENGINEERING DIV.			
CH. ENVIRONMENTAL DIV.			
CH. MAINTENANCE DIV.			
CH. BUSINESS MGMT. DIV.			
CH. HOUSING DIV.			
CH. PREVENTIVE MEDICINE			
USING AGENCY			
REVISION	DATE	DESCRIPTION	BY
PUBLIC WORKS BUSINESS CENTER FORT CAMPBELL, KENTUCKY			
PROJECT REVIEWED AND WILL NOT RESULT IN ADVERSE ENVIRONMENTAL IMPACT CODE			
SCALE	AS SHOWN		
DRAWN BY	ED		
DESIGNED BY	LNG		
CHECKED BY	HJB		
APPROVED			
DATE	Sep 2003		
DRAWING NUMBER	SHT. 15 OF 27 S01		
SR. ENGR.	DIRECTOR, PUBLIC WORKS BUSINESS CENTER		

STORM SEWER SYSTEM

MATCH SHEET 10

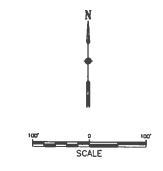

THIS DRAWING HAS BEEN
REDUCED TO ONE HALF
THE ORIGINAL SCALE

	3	4	5				
6	7	8	9	10			
11	12	13	14	15			
16	17	18	19	20	21	22	
		23	24	25	26	27	
		28	29	30	31	32	
		33	34	35	36	37	38
			39	40	41	42	43
			44	45	46	47	48
49	50	51	52	53	54	55	
56	57	58	59	60	61	62	
63	64	65	66	67	68	69	
70	71	72	73	74	75	76	
77	78	79	80				
	81	82					
	83	84					
	85	86					
	87						

KEY MAP

E 1529603

E 1529603

MATCH SHEET 20

E 1529603

E 1546603

NOTES:

- AERIAL PHOTOGRAPH DATE - 2001
- SURVEY COMPLETION DATE - NOT APPLICABLE
- 500' GRID BASED ON TENNESSEE STATE PLANE COORDINATE SYSTEM
 - HORIZONTAL DATUM NAD83
 - VERTICAL DATUM NAVD83
- NFV - NOT FIELD VERIFIED
STRUCTURE WAS SHOWN ON PREVIOUS DOCUMENTS BUT WAS NOT FOUND DURING FIELD INVESTIGATIONS.
STRUCTURE HIGHLY LIKELY TO EXIST DENOTED BY @ AND ■
STRUCTURE OF QUESTIONABLE EXISTENCE DENOTED BY ○ AND □
ASL - ASSUMED LOCATION
STRUCTURE WAS NOT SHOWN ON PREVIOUS DOCUMENTS OR FOUND DURING FIELD INVESTIGATIONS BUT EXISTENCE IS HIGHLY LIKELY.

UTILITY LEGEND

- 48" RCP - STORM SEWER LINE (SEE SUPPLEMENT ENTITLED "STRUCTURE AND PIPE ELEVATIONS, SIZES, AND MATERIALS" FOR ADDITIONAL INFORMATION)
- UNKNOWN ORIGIN OR ENDPOINT OF STORM SEWER LINE
- MANHOLE AND MANHOLE NUMBER
- ⊙ MANHOLE OF QUESTIONABLE EXISTENCE (SEE NOTE 4)
- INLET AND INLET NUMBER
- ⊠ INLET OF QUESTIONABLE EXISTENCE (SEE NOTE 4)
- ⊡ ROOF DRAIN OR OTHER SMALL DIAMETER SUBSURFACE DRAINAGE PIPE
-) PIPE OR CULVERT END OR ENDWALL
-) FLOW DIRECTION ARROWS
- NFV NOT FIELD VERIFIED (SEE NOTE 4)
- ASL ASSUMED LOCATION (SEE NOTE 5)
- ⊙ CLASS V SINKHOLE
- ⊙ NON-CLASS V SINKHOLE

MATERIALS OF CONSTRUCTION

- C - CONCRETE
- CI - CAST IRON
- CM - CORRUGATED METAL PIPE
- PVC - POLYVINYL CHLORIDE
- RCP - REINFORCED CONCRETE PIPE
- VCP - VITRIFIED CLAY PIPE
- PLASTIC
- STEEL

PROJECT NUMBER			
REVIEWED APPROVED			
THE SIGNATURES APPEARING IN THIS BLOCK CONSTITUTE APPROVAL OF ALL DRAWINGS IN THIS PROJECT. ORIGINAL SIGNED AND ON FILE.			
REVISION	DATE	DESCRIPTION	BY
TITLE		SIGNATURE	DATE
CH. PUBLIC SAFETY			
CH. FIRE DEPT.			
CH. MASTER PLANS			
CH. ENGINEERING DIV.			
CH. ENVIRONMENTAL DIV.			
CH. MAINTENANCE DIV.			
CH. BUSINESS MGMT. DIV.			
CH. HOUSING DIV.			
CH. PREVENTIVE MEDICINE			
USNR AGENCY			
SCALE		AS SHOWN	
DRAWN BY		EG	
DESIGNED BY		LMS	
CHECKED BY		HEB	
APPROVED			
SR. ENGR.		DIRECTOR, PUBLIC WORKS BUSINESS CENTER	
		DATE: Sep 2003	
		DRAWING NUMBER: ST-15 OF 87 SH-1	

STORM SEWER SYSTEM